

Wireless 2-Way Keyfob Configuration and User Guide

Model: RMC743 / RMC786

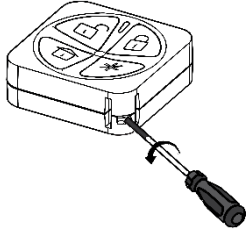

Figure 1

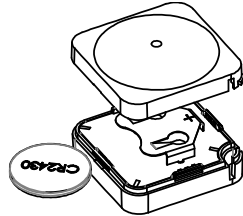

Figure 1

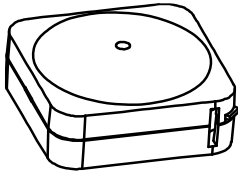

Figure 2

EN

1. Introduction

PIMA's new Wireless 2-Way Keyfob / Remote Control combine the most advanced technologies within a contemporary, compact and streamlined design, the ideal choice for homeowners seeking the highest security standards. The keyfob / remote control has been designed for use in family homes, apartments or small offices. This accessory is easy to configure and is compatible with PIMA's FORCE and VISION intrusion systems.

How it works

The principal function of the Keyfob / Remote Control is to provide users with a convenient way to control the security system. This accessory is easy to use with large keys and is typically used for arming and disarming as well sending a panic alarm to the system. Being bi-directional enables each command that is sent to the panel to receive a reply status from the panel and indicate the status to the user via the color LEDs. The Keyfob / Remote Control can be mounted on a chain or worn as a pendant.

Main features

- Bi-directional wireless communication
- Simple battery replacement

2. Operation

Button	Pressed (0.5sec – 2sec)	Hold (over 2sec)
	Disarm	Disarm
	Arm	Arm
	Home	Home with entry delay canceled
	Get status	Output toggle
	-	Panic alarm
	-	Enroll (see Configuration section)

3. Status LED Indications

The LED lights up after each press, indicating a successful signal transmission.

Operation	1st LED (Send command)	2nd LED (Receive status)
Full Arm (Away)	Green	Red
Part Set (Home Arm)	Green	Orange
Disarm	Green	Green
Alarm	Green	Blinks red
Low battery	Orange	-
UO (activation)	Green	Blinks according to panel status

4. Configuration

Enrollment the Keyfob / Remote Control to the receiver

The 2-Way Keyfob / Remote Control must be enrolled to the system receiver. Enrollment can be done by entering the keyfob's serial number into the system or by using RF mode.

Auto Enrolling (using RF Communication):

1. Enter Installer menu, and select: System Configuration > Peripherals > Wireless Peripherals > Enroll and delete > Keyfobs > Enroll > Auto Enrollment
2. Send an enrollment message by pressing the + keys for at least 2 seconds.
3. Select Enroll and press .

Manual Enrolling:

1. Enter Installer menu, and select: System Configuration > Peripherals > Wireless Peripherals > Enroll and delete > Keyfobs > Enroll > Manual Enrollment
2. Enter the serial number and press .
3. Select Enroll and press .

In both instances the system receiver will automatically recognize the Keyfob / Remote Control and an enrollment message will sound. The LED on the Keyfob / Remote Control will blink.

Enrolling through the Force Manager Software:

You can enroll the keyfob using Force Manager software; For information refer to the Force Manager Manual.

5. Cleaning and Maintenance

Cleaning the Keyfob / Remote Control

Clean the Keyfob / Remote Control with a dry or damp cloth to remove dirt or dust. Do not expose the keys directly to liquid.

Replacing the Keyfob / Remote Control battery

1. Using a small screwdriver, twist to open the Keyfob / Remote Control (see Figure 1).
 2. Remove the old battery.
 3. Press any one of the keys.
 4. Insert the new battery (see Figure 2).
 5. Close the Keyfob / Remote Control cover (see Figure 3).
- Replace the batteries once a year or whenever the low battery LED indicates.

6. Technical Information

SPECIFICATIONS	
Frequency:	433.92, 868.65 MHz
Battery Type:	CR2430, 3V lithium, 280 mA
Power Output	868.65MHz: 10 mW
Typical Battery Life:	4 years
Low Battery Threshold	2.5V
Quiescent Current Consumption	4 µA
Maximum Current Consumption	30 mA
Dimensions (H x W x D):	41 x 41 x 17 mm (1.60 x 1.60 x 0.70")
Operating temperature:	-10° C to 55° C (14 °F to 131 °F)
Average Relative Humidity	75%
Weight	20 gram (0.7 oz.)
Standards	EN50131-3 Grade 2, Environmental Class II, EN50131-6: Type C PD6662:2017

7. Ordering Information

Model	Frequency	P/N
RMC743	433MHz	8843208
RMC786	868MHz	8843209

UKCA and CE RED Compliance Statement:

Hereby, PIMA declares that this equipment is in compliance with the essential requirements of the UKCA Radio Equipment Regulations 2017 and CE Directive 2014/53/EU.

For the UKCA and CE Declaration of Conformity please refer to our website: www.pima-alarms.com

Limited Warranty

PIMA Electronic Systems Ltd. does not represent that its product may not be compromised and/or circumvented, or that the Product will prevent any death, personal and/or bodily injury and/or damage to property resulting from burglary, robbery, fire or otherwise, or that the Product will in all cases provide adequate warning or protection. The User understands that a properly installed and maintained equipment may only reduce the risk of events such as burglary, robbery, and fire without warning, but it is not insurance or a guarantee that such will not occur or that there will be no death, personal damage and/or damage to property as a result.

Read this guide in its entirety before attempting to program or operate your system. Should you misunderstand any part of this guide, please contact the supplier or installer of this system. Copyright © 2020 PIMA Electronic Systems Ltd. All rights reserved. E&OE

Contacting PIMA

PIMA Electronic Systems Ltd.

www.pima-alarms.com

5, Hatzoref Street, Holon 5885633, Israel

Tel: +972.3.6506414

Fax: +972.3.5500442

Email: support@pima-alarms.com



Scan for technical documentation



© PIMA 05/2022 4412992-A

5IN2